

B1-PRO/B1-FRS/RAM/BOW

**SUSPENSION FORKS
OWNER'S MANUAL**

Shock Works C.C forks are designed to balance high performance with ease of maintenance. This manual contains important information about the proper installation, operation and maintenance of your fork. We urge you to read it carefully, become familiar with its components and follow our recommendations to help make your mountain bike experience enjoyable and trouble free.

Consumer Safety Information

FAILURE TO FOLLOW THIS INSTRUCTIONS COULD SUFFER SERIOUS FATAL INJURY AND/OR DAMAGE THE FORK.

1. Before riding the bicycle, be sure the brakes are properly installed and adjusted. If the brakes don't work properly, the rider could suffer serious and/or fatal injuries.
2. The fork is only intended and approved for use with V-type and disc brakes. Do not use any cantilever brakes other than those intended by the brake manufacturer to work with a hangerless brace.
3. Use with extreme caution not to tilt the bicycle to either side when mounting the bicycle to a carrier by the fork drop-outs (front wheel removed). The fork legs may suffer structural damage if the bicycle is tilted while the drop-outs are in the carrier. If the bicycle tilts or falls out of its carrier, do not ride the bicycle until the fork is properly examined for possible damage. Return the fork to your dealer for inspection or call Shock Works distributors if there is any question of possible damage (See Shock Works distributors list in different countries on cover page). A fork leg or dropout failure could result in loss of control of the bicycle with possible serious and/or fatal injuries.
4. If the fork ever loses oil or if it makes sounds of excessive topping out, stop riding the bicycle immediately and inspect the fork by a qualified technician or call Shock Works distributors. Continuing to ride with the fork in either of those conditions could result in loss of control of the bicycle with possible serious and/or fatal injuries.
5. Always use genuine Shock Works parts, use of non-Shock Works after market replacement parts voids the warranty and could cause structural failure to the fork. Structural failure could result in losing control of the bicycle with possible and /or fatal injuries.

IMPOERANT : Shock Works forks are designed for offroad use and there fore do not include reflectors and other possible safety devices which might be mandated by local laws for use on roads and highways. Your dealer should install proper safety reflectors and/or other necessary devices to meet the Consumer Product Safety Commission's (CPSC) requirements for bicycles standard if the fork is going to be used on public roads at any time.

6. This product is not intended for use in stunt riding, ramp jumping, direct jumping, acrobatics, or similar activities. The user assumes the risk of any personal injuries, product damage/failure, and any other losses which may arise under such use. Shock Works shall not be held responsible for any incidental or consequential damages.

Installation Instructions

IT IS EXTREMELY IMPORTANT THAT YOUR SHOCKWORKS FORK IS INSTALLED CORRECTLY BY A QUALIFIED TECHNICIAN WITH PROPER TOOLS. IMPROPERLY INSTALLED SHOCKWORKS FORKS ARE EXTREMELY DANGEROUS AND CAN RESULT IN SEVERE AND/OR FATAL INJURIES.

1. Install the headset race as per manufacturer's instructions.

IMPORTANT: Do not add threads to Shock Works steerers. Do not remove or replace the steerer tube, because this could result in loss of control of the bicycle with possible serious and/or fatal injuries.

2. Remove the existing fork and lower headset race from the bicycle. Measure the length of the fork steerer tube against the length of the Shock Works steerer. The Shock Works steerer tube may need cutting to the proper length. On threadless steerers (Ahead set design), make sure there is sufficient length to properly clamp the stem (refer to stem manufacturer's instructions).

3. Install the Ahead set race (24.5mm inner diameter for 1-1/8" steerers) firmly against the top of the fork crown. Ensure crown is properly seated.

4. Clean, grease and install headset bearings.

5. Install the fork assembly onto the bike. Make sure there is sufficient length to properly clamp the stem (refer the stem manufacturer's instructions). Adjust the headset so you feel no play or drag.

6. Install handlebar stem per manufacturer's instructions.

7. Install brakes per manufacturer's instructions. We recommend installing new brake cables when you install your new Shock Works fork.

8. Shock Works forks have been designed to accommodate tires up to and including 26"x2.6". We recommend a minimum clearance of 15mm during full compression to ensure proper tire clearance.

Turning Your Fork

1. Pre-load

Pre-load can be adjusted by turning the yellow adjuster knobs located at the top of right fork tube by hand. Turn clockwise to increase pre-load, counter-clockwise to decrease pre-load.

2.Damping Adjustment

Damping can be adjusted by turning the adjuster knob located at the top of the left leg, blue knob is compression adjuster and red knob is rebound adjuster.

Turn clockwise to increase damping, counter-clockwise to decrease damping.

3. When pre-load adjustments do not yield satisfactory results for your weight and/ or riding style, you can alter the stiffness of the spring comp by replacing them in the following manner:

Fork Travel	Standard	Harder	Hardest
185mm	1 hard+2 soft	2 hard+1 soft	3 Hard
153mm	2 soft	1 soft+1 hard	2 Hard
123mm	1 soft	1 hard	

Maintenance

To maintain high performance, safety and long life, periodic maintenance is required. Shock Works forks are designed for easy service to help you keep the fork clean, greased and performing like new. Frequent maintenance is necessary if you ride in extreme conditions. The recommended tools, intervals and maintenance are listed below.

Maintain Tools

- 1.4,5mm allen key
- 2.19,30mm open-end wrench(for axle).

Torque Tightening Table

Adjust comp/	hand tighten
Crown bolt	8.7ft-lbs (120kg-cm)
Pivot	10.8ft-lbs (150kg-cm)
Shaft bolt	8.7ft-lbs (120kg-cm)

Pre-Ride Maintenance

Before every ride, inspect the following parts:

- 1.Front wheel and quick release for proper installation and adjustment.
- 2.Fork for any obvious damage (crown, buace, upper tubes, lower tubes, and dropouts).
- 3.Front brake cable for proper routing.
- 4.Front brake pads for proper contact with the rim.
- 5.Front brake lever for proper adjustment.
- 6.Headset for proper function and adjustment.
- 7.Fasteners (Adjust Comp pivots and shaft bolts) for proper torque (see table above).If any damage is detected, do not ride your bike. Contact Shock Works distributor or your local Shock Works dealer immediately.

General Maintenance

After monthly or 30 hours of riding, clean and grease the spring comp, inner rod, bushings and dust seal.

Dissassembly

- 1.Loosen the shaft bolt with a 5mm allen key.
- 2.Loosen the pre-load adjuster comp bolt by hand.
- 3.Remove the spring comp and clean the remaining grease.
- 4.Loosen the shaft bolt with a 5mm allen key.
- 5.Remove the lower tubes/ brace assembly(one complete unit) from the upper tube/ crown assembly.

Clean and grease the parts

- 1.Clean upper tube and inspect for wear and/or damage. Clean the internals of lower tubes, bushings (two per leg) and dust seal.
- 2.Apply a thin coat of grease to spring comp, dust seal and bushings in the lower tubes.
- 3.All parts should be cleaned thoroughly with a non-corrosive solvent. Solvents such as carb should not be used as it may dissolve rubber parts. Highly volatile solvents such as gasoline should not be used as the danger from fire is too greatl. After cleaning, dry each component completely.

Re-assembly

- 1.Insert the spring comp and pre-load adjuster comp in the upper tube. Then hold the upper tube and lock up the adjuster comp bolt by hand.
- 2.Use a 5mm allen key to lock the crown bolts and torque to 8.7ft-lbs(120kg-cm).
- 3.Insert the upper tube/ crown assembly carefully in the lower tube/ brace assembly without damaging the dust seal, aiming at the inside diameter of the two guide bushings.
- 4.Insert the shaft bolts on the outer slot of the lower tube and use a 5mm allen key to lock it up.
- 5.Press down on the fork several times and wipe the brimming grease.

Warranty

Shock Works fork provides one year warranty from the original date of purchase of the bicycle/fork to cover only defective materials or workmanship. ID number and a copy of the original purchase receipt must accompany any fork being considered for warranty service. User is supposed to understand all risks of personal injures, damage to the product when it is used in stunt, acrobatics or similar activities. The warranty does not apply if the fork has been damaged due to improper installation and/or adjustment. This warranty does not cover any incidental or consequential damages, such as personal injures, or any other losses due to accident, abuse, disassembly, modifications, extreme impact and normal wear and tear.

B1-PRO/FRS Exploded View

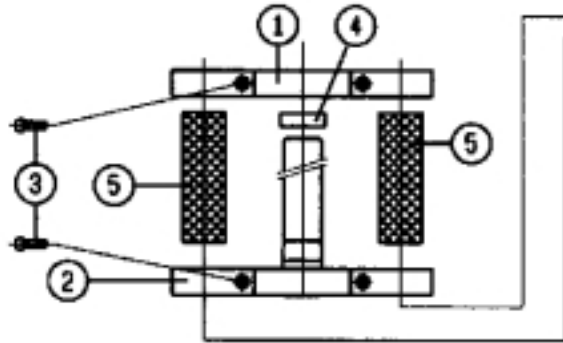

B1-PRO/FRS Spare Parts

NO.	Items
1	UPPER
2	CROWN ASS'Y
3	BOLT
4	SPACER
5	UPPER BOOT
6	ADJUSTER COMP
7	SPRING COMP
8	UPPER TUBE
9	INNER ROD COMP
10	CIRCLIP
11	FORK BOLT
12	O.RING
13	ADJUST COMP
14	MAIN PIPE
15	PISTON ROD COMP
16	CARTRIDGE COMP
17	DUST SEAL
18	R LOWER TUBE
19	L LOWER TUBE
20	BOLT
21	DISK MOUNT
22	BRACE
23	BOLT
24	AXLE COMP

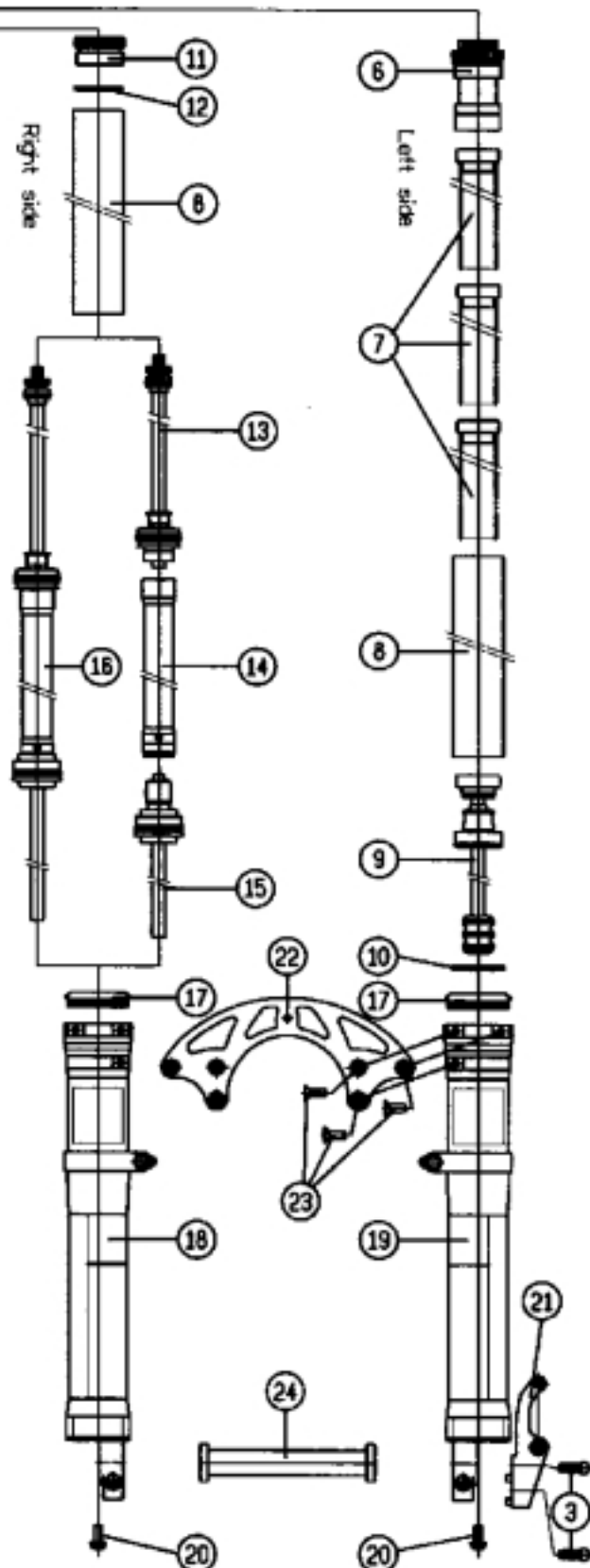

RAM/BOW Exploded View

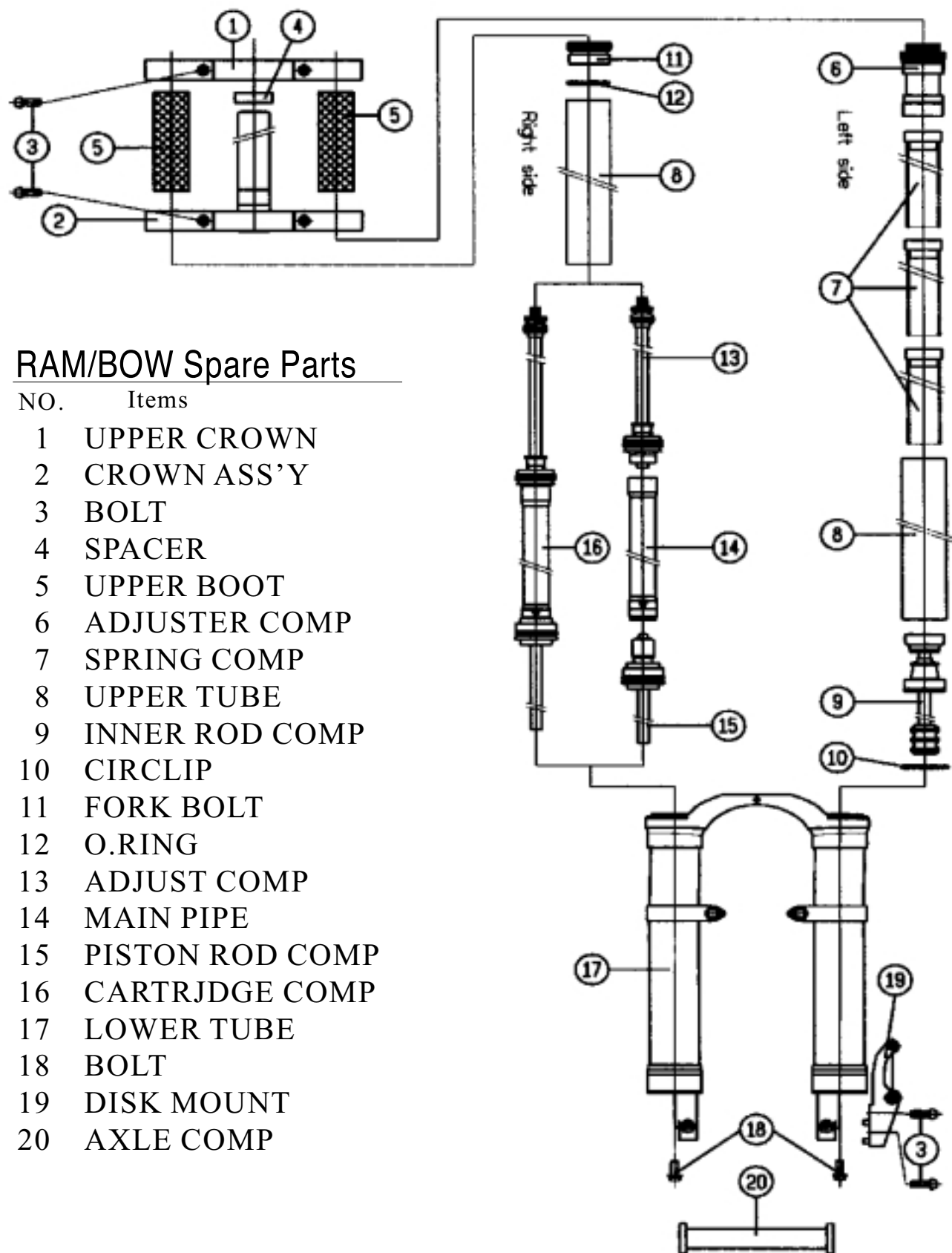

RAM/BOW Spare Parts

NO.	Items
1	UPPER CROWN
2	CROWN ASS'Y
3	BOLT
4	SPACER
5	UPPER BOOT
6	ADJUSTER COMP
7	SPRING COMP
8	UPPER TUBE
9	INNER ROD COMP
10	CIRCLIP
11	FORK BOLT
12	O.RING
13	ADJUST COMP
14	MAIN PIPE
15	PISTON ROD COMP
16	CARTRIDGE COMP
17	LOWER TUBE
18	BOLT
19	DISK MOUNT
20	AXLE COMP