

### Using T25 Torx

Tighten disc brake rotor bolts with the T25 Torx bit.

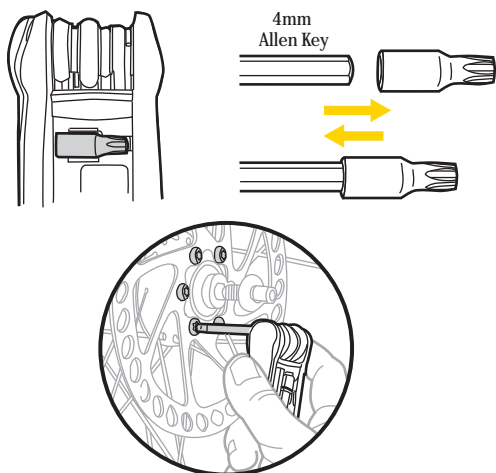

### Using 5mm and 8mm Allen Keys

These two tools are combined.  
Slide down the 8mm Allen head to use the 5mm Allen key.  
Slide up to use the 8mm Allen key.

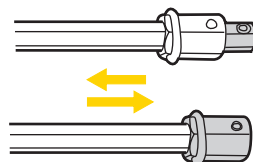

### Tool maintenance

Using 4mm on tire lever to adjust the folding resistance.

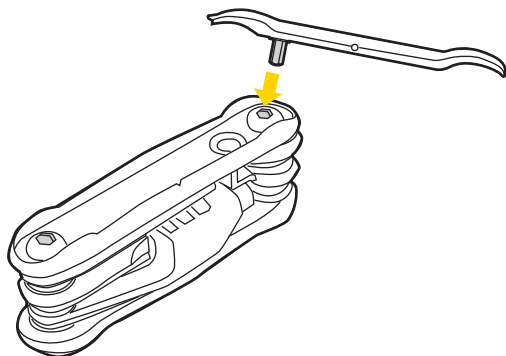

### Using Chain Hook and Chain Tool

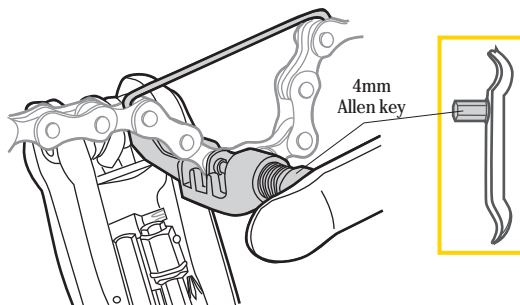

### Using Tire Levers

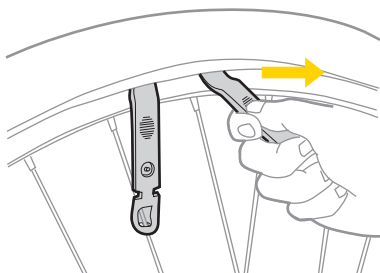

### Using Air Pressure Release Button

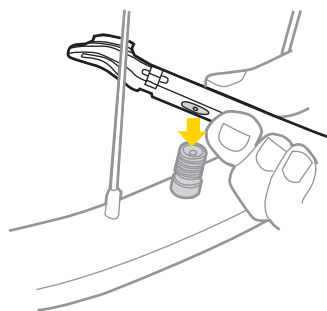

#### NOTE:

Lubricate and maintain HEXUS tool with teflon based lubricant when needed. To prevent rusting, keep HEXUS tool dry.

#### LIMITED WARRANTY

2-year Warranty: All mechanical components against manufacturer defects only.

#### Warranty Claim Requirements

To obtain warranty service, you must have your original sales receipt. Items returned without a sales receipt will assume that the warranty begins on the date of manufacture. All warranties will be void if The HEXUS is damaged due to user abuse, tool or body alterations, modification, or used in any way not intended as described in this user's guide.

\* The specifications and design are subject to change without notice.

Topeak products are available only from professional bicycle shops.  
Please contact your nearest Topeak authorized bicycle dealer for any questions.  
For customers in the USA, call: 1-800-250-3068 Website: [www.topeak.com](http://www.topeak.com)